

Scan to save a copy



Recon™ 2-Blade Weedless Propeller Installation Guide

⚠ WARNING: This product must be installed in accordance with the instructions provided. Failure to do so could result in personal injury, damage to your vessel and/or poor product performance.

⚠ WARNING: Performing service or maintenance without first disconnecting the battery can cause product damage, personal injury, or death due to fire, explosion, electrical shock, or unexpected motor starting. Always disconnect the battery cables from the battery before maintaining, servicing, installing, or removing motor components.

In the box

- 1x 2-blade weedless propeller
- 1x brass M10 Nylock nut
- 1x M10 316SS washer

Tools needed

- 17 mm (11/16") deep socket
- 17 mm (11/16") socket wrench
- Pliers
- Gloves

Installation

To remove the existing propeller:

- 1 Disconnect the trolling motor power cable from the battery (or unplug the power cable if using a plug and receptable).
 - 2 While holding the propeller blade with one gloved hand, use a 17 mm (11/16") deep socket to remove the propeller nut (B) and washer (C). If you have a saltwater Recon™ trolling motor, you'll also need to remove the propeller shaft anode (A).
- **Note:** Using alternative tools can damage the propeller nut or shaft.

- 3 If you can't remove the propeller easily, use a rubber mallet to lightly tap the back side of the opposite blade.
- **Note:** If you still can't remove the propeller, or the propeller pin (D) is bent during removal of the propeller, see an authorized dealer.

To attach the new Recon™ propeller:

- 4 Clean the threads of the propeller shaft of any grease and debris.
- **Note:** You don't need anti-seize compound when using a brass propeller nut.
- 5 Align the slot in the propeller (A) with the pin on the lower unit (B).

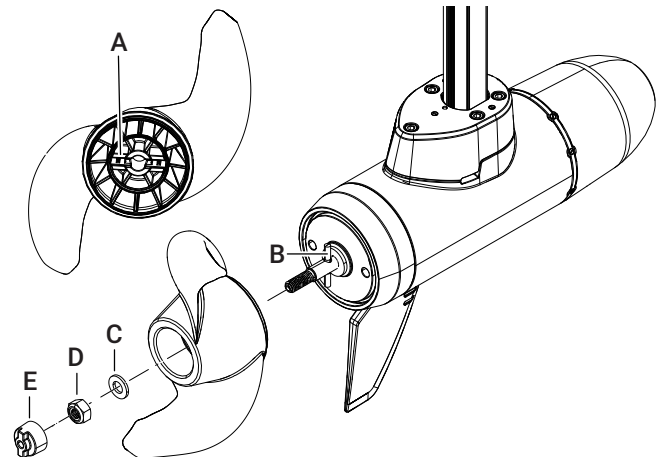

- 6 Attach the propeller to the lower unit.
 - 7 Attach the washer (C) and propeller nut (D).
- **Note:** A new brass M10 Nylock nut and stainless steel washer are supplied if your existing ones are damaged.
- 8 Secure the nut using a 17 mm (11/16") deep socket. Tighten to torque 9 Nm (80 in-lb).

⚠ WARNING: Do not use power tools to install the propeller nut to avoid overtightening. Overtightening can cause damage to the propeller or propeller pin.

- 9 If you have a saltwater Recon™ trolling motor, re-install the propeller shaft anode (E).
- **Note:** The propeller shaft anode is also sold as a separate accessory.

