

Scan to save a copy



Trolling Motor ActiveTarget® 2 Mounting Kit Installation Guide

⚠ WARNING: This product must be installed in accordance with the instructions provided. Failure to do so could result in personal injury, damage to your vessel and/or poor product performance.

⚠ WARNING: Performing service or maintenance without first disconnecting the battery can cause product damage, personal injury, or death due to fire, explosion, electrical shock, or unexpected motor starting. Always disconnect the battery cables from the battery before maintaining, servicing, installing, or removing motor components.

In the box

- 1x forward/down bracket, 1x rubber washer, 1x M8 metal washer, 1x shoulder bolt
- 1x Scout™ bracket (hardware not supplied)
- 4x M5 x 12 screws
- 2x cable routing arms, 6x M5 x 20 screws
- 1x coiled tubing

Tools needed

- 3 mm flathead screwdriver or 2.5 mm (3/32 in) Allen key (depending on the type of plastic plugs that came with your trolling motor)
- 3 mm (1/8 in), 4 mm (5/32 in), 5 mm (3/16 in) Allen keys
- Razor blade or tube cutter
- 10 mm (3/8 in) open-end wrench or large flathead screwdriver

Mount transducer

- 1 Position the trolling motor in the deployed position.
- 2 Disconnect the trolling motor power cable from the battery (or unplug the power cable if using a plug and receptacle).
- 3 There are six attachment points between the nose cone and lower unit for mounting live sonar transducers. There are two on each side (for forward and down views) and two on the top (for Scout™ view). Remove the plastic plugs from the two attachment points you want to use with a 3 mm flathead screwdriver or 2.5 mm (3/32 in) Allen key (depending on the type of plastic plugs that came with your trolling motor).

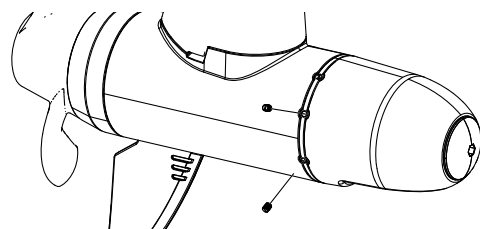

→ **Note:** Keep the plugs in case you ever decide to remove the transducer from your trolling motor.

- 4 To mount a transducer in forward/down view:
 - a Use a 5 mm (3/16 in) Allen key and the supplied bolt (A), metal washer (B) and rubber washer (C) to attach the forward/down bracket to the transducer.

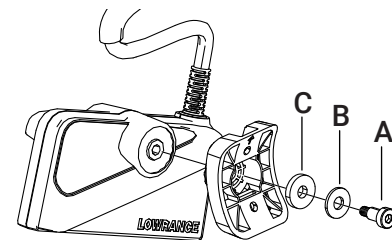

- b Use two of the supplied M5 x 12 screws and a 3 mm (1/8 in) Allen key to attach the forward/down bracket to two side attachment points on the lower unit.

→ **Note:** Take extra care to ensure the screws are aligned with the threaded holes before tightening to prevent damaging the threads in the lower unit.

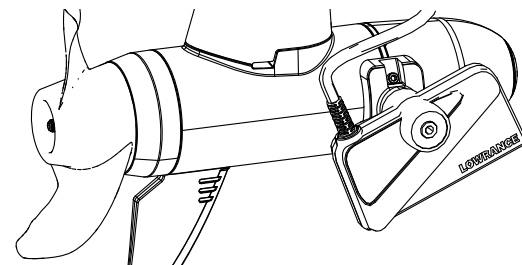

- c Once attached to the motor, orient the transducer to the down or forward view by firmly gripping and rotating the transducer until the alignment marks match.

→ **Note:** For more information on aligning the transducer, refer to the installation manual that came with your ActiveTarget® 2 transducer.

- 5 To mount a transducer in Scout™ view:
 - a Use a 5 mm (3/16 in) Allen key and the M6 x 20 cap screw, M6 metal washer and Scout™ bracket arm that came with your ActiveTarget® 2 transducer to mount the Scout™ bracket arm to your transducer. Align the lines on the arm with the lines on the transducer.

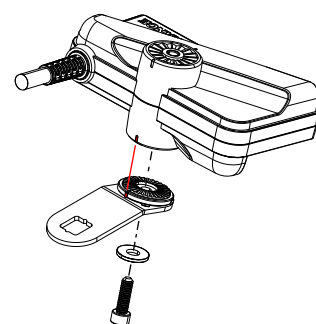

- b Use a 5 mm (3/16 in) Allen key and the remaining M6 x 20 cap screw and M6 metal washer that came with your ActiveTarget® 2 transducer to attach the Scout™ bracket to the other end of the bracket arm.

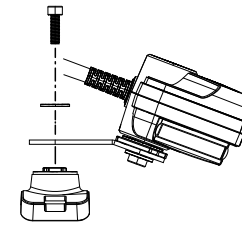

- c Use two of the supplied M5 x 12 screws and a 3 mm (1/8 in) Allen key to attach the Scout™ bracket to the two top (center) attachment points on the lower unit.

→ **Note:** Take extra care to ensure the screws are aligned with the threaded holes before tightening to prevent damaging the threads in the lower unit.

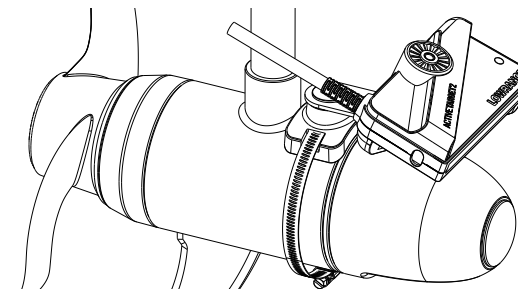

Wrap transducer cable in coiled tubing

- 6 If your trolling motor column is less than 72 inches, cut the supplied coiled tubing to the specified number of coils.

→ **Note:** A coil is one 360° revolution of the tubing about itself.

- 48 inch: 5–5.5 coils
- 54 inch: 5.5–6 coils
- 60 inch: 6.5–7 coils
- 72 inch: 8 coils (uncut)

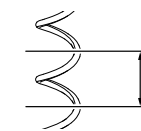

- 7 To make the coiled tubing malleable, soak it in hot water (37°C – 48°C or 100°F – 120°F) for 10 minutes.
- 8 Use a 10 mm (3/8 in) open-end wrench or large flathead screwdriver to separate the split in the coiled tubing, then, starting 20–25 cm (8–10 in) from the transducer, insert the transducer cable into the tubing so the tubing acts as a flexible sheath. Do not press directly on the transducer cable with the wrench or screwdriver.

Mount cable routing arms and route cables

- 9 Use the 4 mm (5/32 in) Allen key and four of the supplied M5 x 20 screws to attach one cable routing arm to the column just above the lower unit tower and the other just under the trolling motor head.

→ **Note:** The top of the lower cable routing arm cannot be more than 22 mm (7/8 in) above the lower unit tower or the trolling motor will not stow properly.

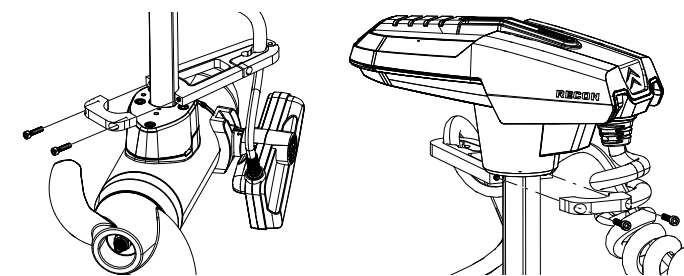

- 10 Route the exposed transducer cable (the end not covered by the coiled tubing) through the center of the coil cable that runs between the trolling motor head and mount (A). Connect the transducer cable to the sonar module.
- 11 Route the bottom of the coiled tubing through the lower routing arm and position so the tubing ends 6–12 mm (0.25–0.5 in) below the arm (B) and the coil exiting the top of the arm faces away from the column (towards the nose) (C). Route the top of the coiled tubing through the top of the upper routing arm (D) and position so the tubing ends 6–12 mm (0.25–0.5 in) below the arm (E).
- 12 Use the 4 mm (5/32 in) Allen key and two remaining M5 x 20 screws to secure the pivot arms and tubing in place.

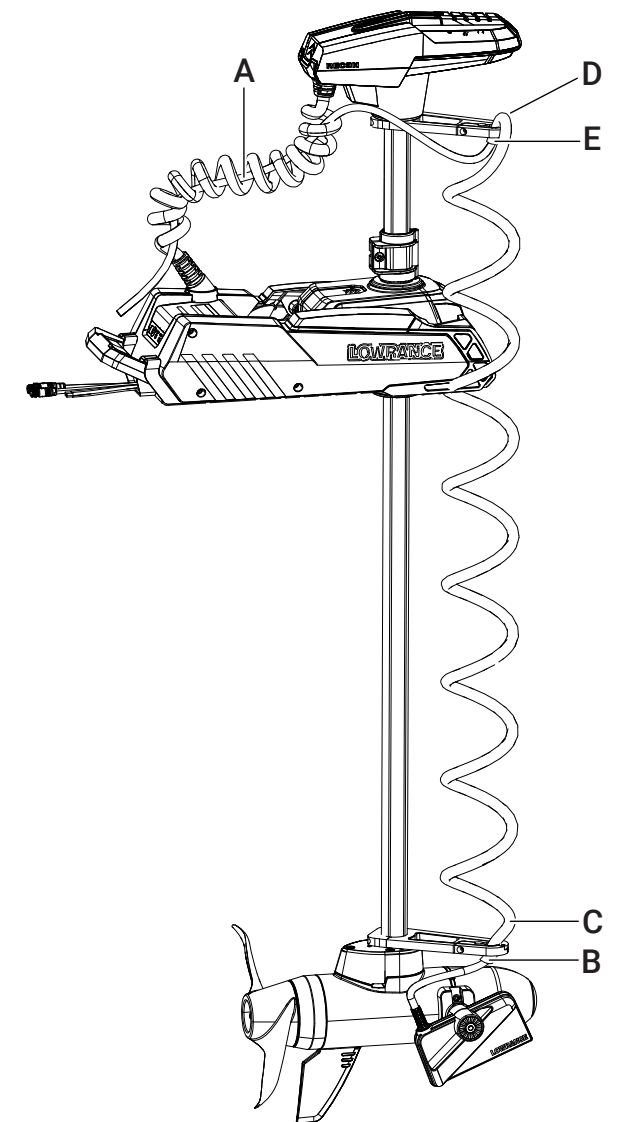

- 13 Check there are no cable pinch points and there is enough slack in the coiled tubing so it doesn't get caught on the mount or restrict steering movement, and that the motor can fully rotate left/right when using the remote control.

→ **Note:** Make sure you program your trolling motor's auto-stow alignment feature so the transducer faces away from the boat to prevent damage when stowing.