



Whale®

Superfil



Installation and Operating Instructions



EN

Superfil

Installation and Operating Instructions

The Whale Superfil is designed for use in recreational vehicles to supply freshwater to caravans and motorhomes where socket housings are used to connect to an outside water supply. The Whale Superfil exterior pump range allows an easy, secure connection between socket housings and an external water source. All models come with a flexible hose, strainer and narrow pump design.

GP1332 pack includes:

- High Flow Rate Submersible Pump
- 1.5m Hose
- 2 Pin Plug
- 12V d.c. Socket and Gasket
- Step by Step Instructions

GP1633 pack includes:

- High Flow Rate Submersible Pump
- 1.5m Hose
- 2 Pin Plug
- Step by Step Instructions

The Whale Superfil GP1633 pack is ideal for use with the Whale Easi-Slide Motorhome Filler +12V Socket (Product Code SO2500C).

Safety



- This product is designed for use with freshwater only. If it is intended for use with any other liquid, it is the user's responsibility to ensure that the materials are fully compatible with the liquids to be used.
- With all applications it is important that a system of safe working practice is applied to installation, use and maintenance.
- Do not use the pump in water temperatures above 40°C (100°F).
- It is best to stand the pump vertically in the tank.
- Drop pump into water container and shake to expel any air before inserting the plug into the socket.
- Do not use pump for other purposes other than stated in this document. Please note performance may vary depending on the plumbing system and restrictions on outlets in your recreational vehicle.
- The plug must always be removed from the external water socket before moving the caravan or motorhome and stored in a clean, dry place.

Please note: The manufacturer cannot be held responsible for claims arising from incorrect installation, unauthorised modification or misuse of this product.

Technical Data

Model	GP1332 Superfil with 12V d.c. Socket and Gasket	GP1633 Superfil only
Voltage	12V d.c.	
Pump	Submersible	
Fuse Size	5 Amp Automotive	
Flow Rate Per Minute / Current Draw	0m = 15.8 ltrs / 3.8 amps 1m = 14.8 ltrs / 3.7 amps 3m = 12.8 ltrs/ 3.5 amps	
Materials	ABS, Seals: Nitrile®, polypropylene, PVC	
Service Kit	AS8092 – Socket & Gasket	N/A
Operating Temperature Range (°C)	3°C to 40°C	
Storage Temperature Range (°C)	-30°C to 60°C	

Helpful Hints

To obtain efficient running and maximum pump life, follow these easy steps:

- Ensure there is sufficient water in the container. **Never** let the pump run dry.
- Ensure maximum pumping period is not more than 15 minutes continuous operation.
- Ensure all pump hose connections are firm and watertight.
- Clean contact pins before each use.
- Ensure the power supply is adequate. Low performance could result from a weak battery or reduced voltage due to undersized wiring.
- When replenishing the water supply, it is possible to create an air lock in the pump. As a result, the pump will run noisily and give no flow. To remedy, unplug from the socket while keeping the pump submerged to dislodge the air pocket in the pump. Also shaking the dual hose gently may dislodge the air pocket in the pump. Alternatively switch off pump at main panel, open a tap outlet and switch pump on again at the main panel.

Before You Begin (GP1332 pack only)

- When selecting a suitable position to secure the electrical socket to the wall of the caravan or motorhome, check that the hose will reach the inlet of the water tank and the submersible pump can reach the bottom of the water container with the plug connected.
- Use 1.5mm² cross-section of wire. Using a thinner wire will affect the pump's performance.

WARNING: Always wire the socket before installing onto a caravan or motorhome wall.

WARNING: Before installation, ensure all power to the vehicle is isolated.

Socket Installation (GP1332 pack only)

- A 5 amp automotive fuse **must be** fitted in series along the positive wire. Failure to do so may cause the pump to fail.

Socket Installation (GP1332 pack only)

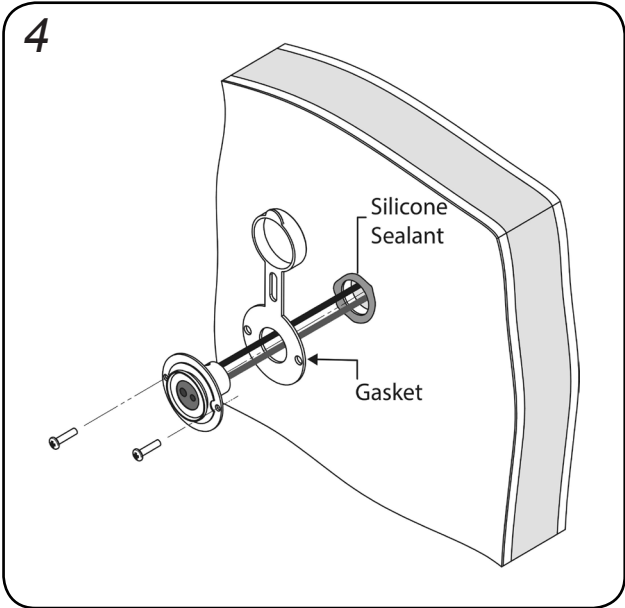
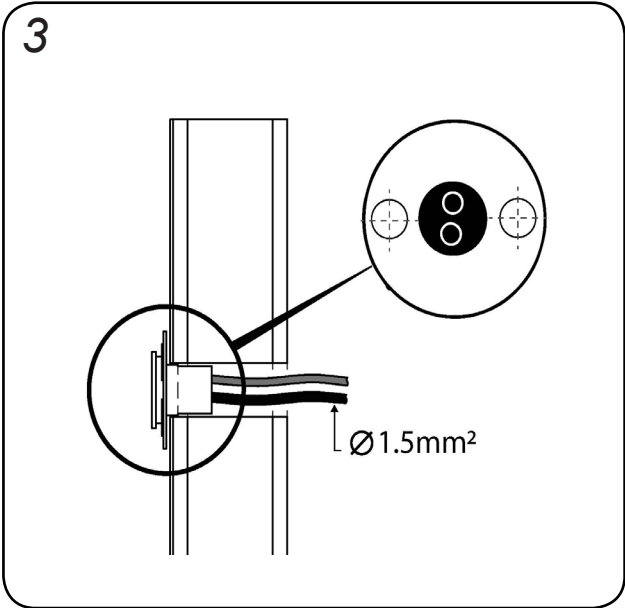
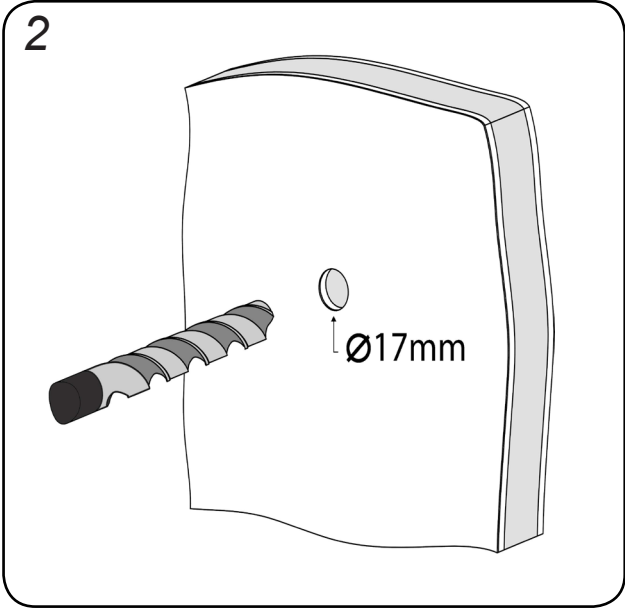
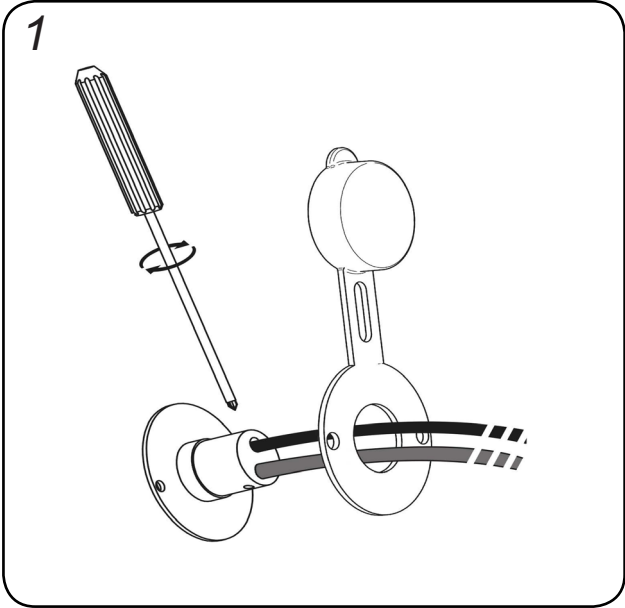

Operation

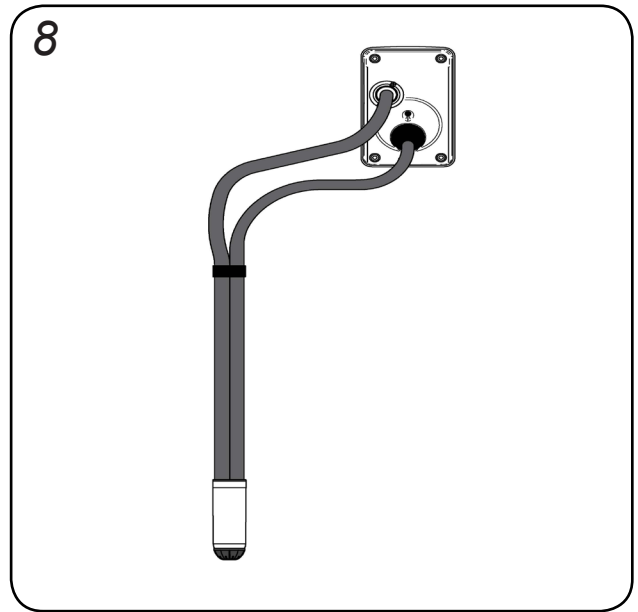
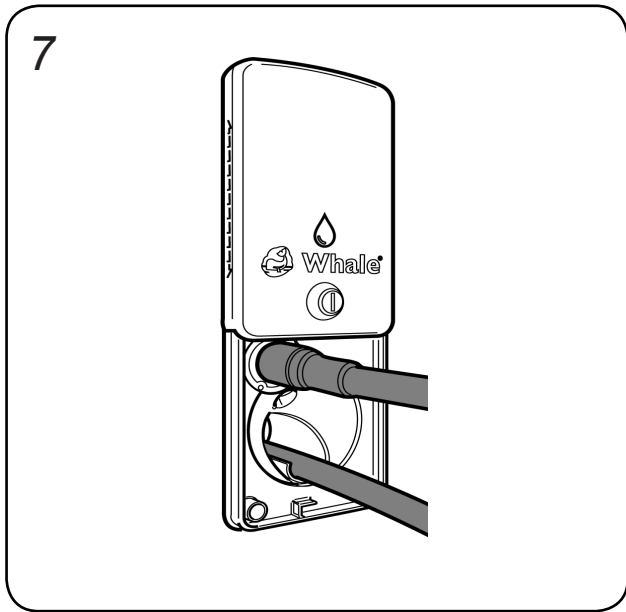
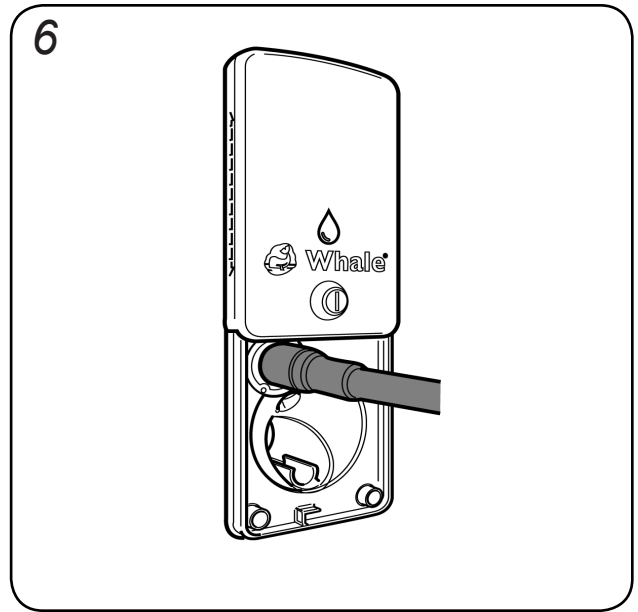
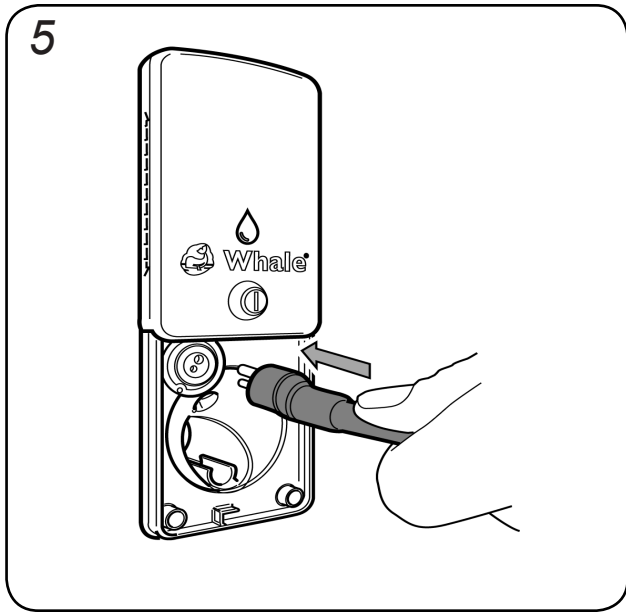

DECLARATION OF CONFORMITY, STANDARDS & APPROVALS

Declare under our sole responsibility that the following apparatus:

Product description: Whale Exterior Pump Range

Model name and no.: Whale Superfil

Brand name: Whale®

Is in conformity with the following relevant EU Legislation:

EMC directive 2004/108/EC

Based on the following harmonized standards:

EN55014-1:2000 EMC Emissions

EN55014-2:1997 EMC Immunity

And therefore complies with the essential requirements of those directives.

Name and position of person binding the manufacturer or authorised representative:

Name: Richard Bovill

Function: Engineering Director

Location: Munster Simms Engineering Ltd

2 Enterprise Road, Bangor, BT19 7TA

Date of Issue: 2009



This Whale product is covered by a 1 year warranty. Please see the enclosed document for details of our Statement of Limited Warranty.

©Copyright Whale 2018 - All rights reserved. Reproduction in whole or in part without permission is prohibited.

WHALE®, is a registered trademark of Munster Simms Engineering Limited, Bangor, Northern Ireland trading as Whale. Whale's policy is one of continuous improvement and we reserve the right to change specifications without prior notice. Illustrations are for guidance purposes only.

Neither the accuracy nor completeness of the information contained in this or any product literature is guaranteed by the Company and may be subject to change at its sole discretion.



Munster Simms Engineering Ltd.
2 Enterprise Road, Bangor, N Ireland, BT19 7TA
Tel: +44 (0)28 9127 0531
+44 (0)845 217 2933
info@whalepumps.com

whalepumps.com

